

Eco Preparation 1600 mm Soaking Sink with 1 Bowl

ITEM # _____
 MODEL # _____
 NAME # _____
 SIS # _____
 AIA # _____



132912 (SLP16N)

Soaking Sink Unit with 1 bowl
(1280x510x340mm), 1600mm

Short Form Specification

Item No. _____

Worktop in 304 AISI stainless steel with front edge h=50mm. Rear upstand h=100mm. N.I bowl 1280X510X340mm. Front and side covering panels in stainless steel. Rear panel in stainless steel. Square section legs 40x40mm in stainless steel with adjustable feet.

Main Features

- Sturdiness, stability and reliability of table accurately tested.

Construction

- Constructed entirely in stainless steel to offer maximum durability.
- Wide range of taps are available to suit every need.
- Pan washing support to use inside the bowl is available as an accessory.

Optional Accessories

- Lower shelf for 1600mm tables PNC 855147 ☐ and sinks
- Set of 4 wheels (2 with brake) PNC 855150 ☐ d. 100mm for tables and sinks (total height on wheels= 993 mm)
- 3-sided underframe for PNC 855154 ☐ 1600mm tables
- Single plastic drain syphon 1,5 PNC 855306 ☐ " for work tables with bowl
- Elbow operated mixer tap with PNC 855322 ☐ spout 3/4", single hole
- Elbow operated mixer tap with PNC 855323 ☐ short spout 3/4", single hole
- Foot operated mixer tap (hot PNC 855328 ☐ and cold) with spout 3/4"

APPROVAL: _____

Key Information:

External dimensions, Width:	
132912 (SLP16N)	1600 mm
External dimensions, Depth:	700 mm
External dimensions, Height:	900 mm
Upstand Dimensions, Height:	100 mm
Upstand Dimensions, Depth:	13 mm
Upstand Dimensions, Radius:	R=10
Bowls number	1
Bowl dimensions	1460x500xH400
Net weight:	65 kg

Front

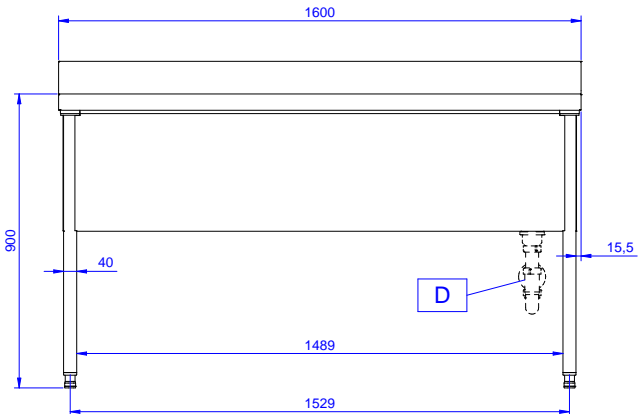

Side

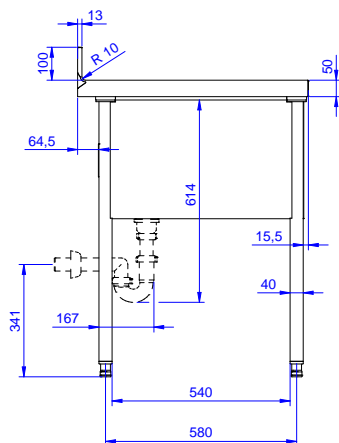

D = Drain

Top

